

Developer by :
DEONE
INFRASTRUCTURE

SUN CITY @ DODDABALLAPURA

Acres=123 (5357880Sqft)

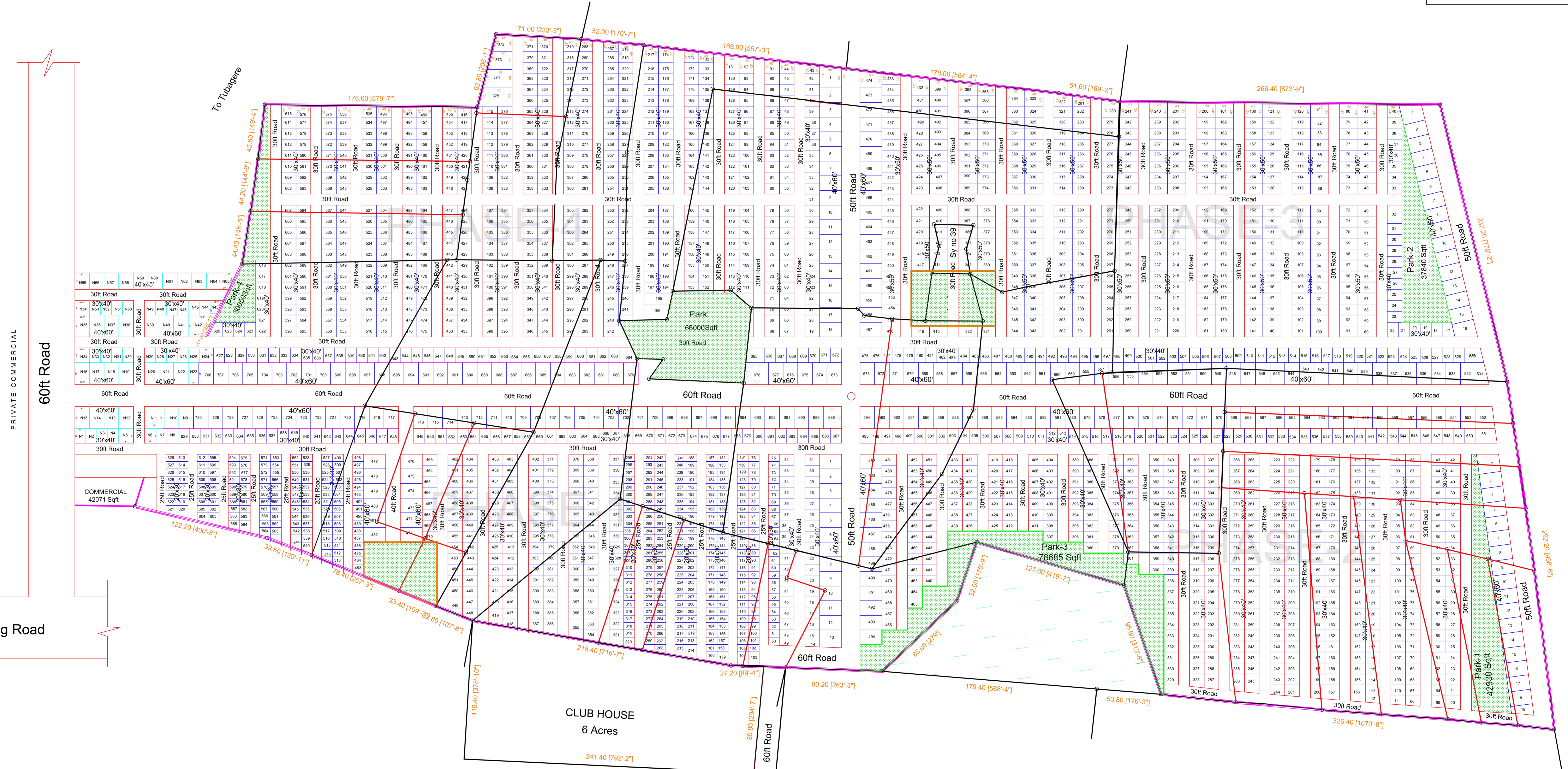
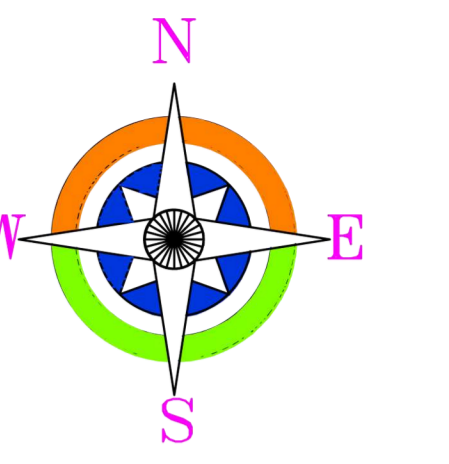

OWNER

LANDUSE ANALYSIS

AREA-STATEMENT

LAND USE	AREA(sqft)	%
RESIDENTIAL	3230656	60.31%
COMMERCIAL	46774	0.87%
ROADS	1805882	33.70%
PARKS	274568	5.12%
TOTAL	5357880	100%

TITLE :

PROPOSED RESIDENTIAL LAYOUT PLAN
 ON SURVEY OF SY NO - 26,27,28,29,37,38,39,40,
 41,43,44,45,46,47,155,156,157,158
 SITUATED IN THIMMASANDRA VILLAGE,
 KASABA HOBLI, DODDABALLAPURA TALUK,
 BANGALORE RURAL DISTRICT.

